

FEED ON BOTTOM SURFACE

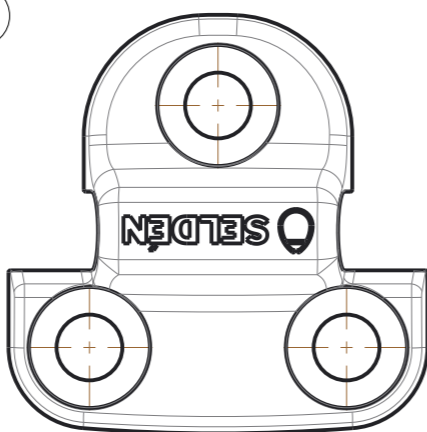
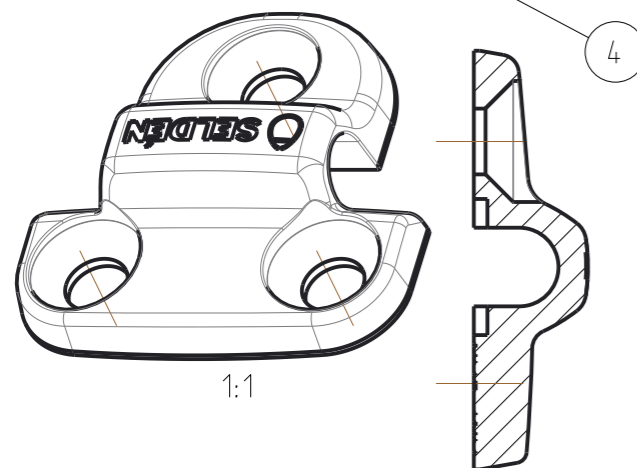
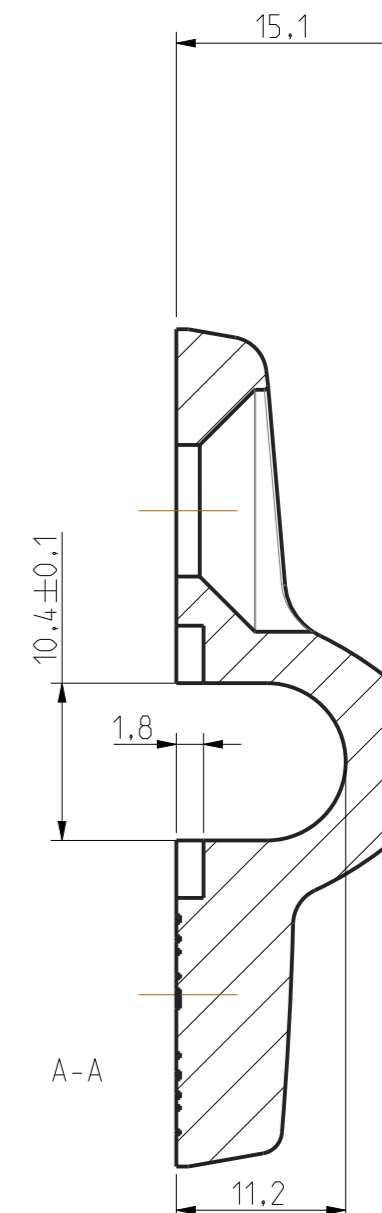
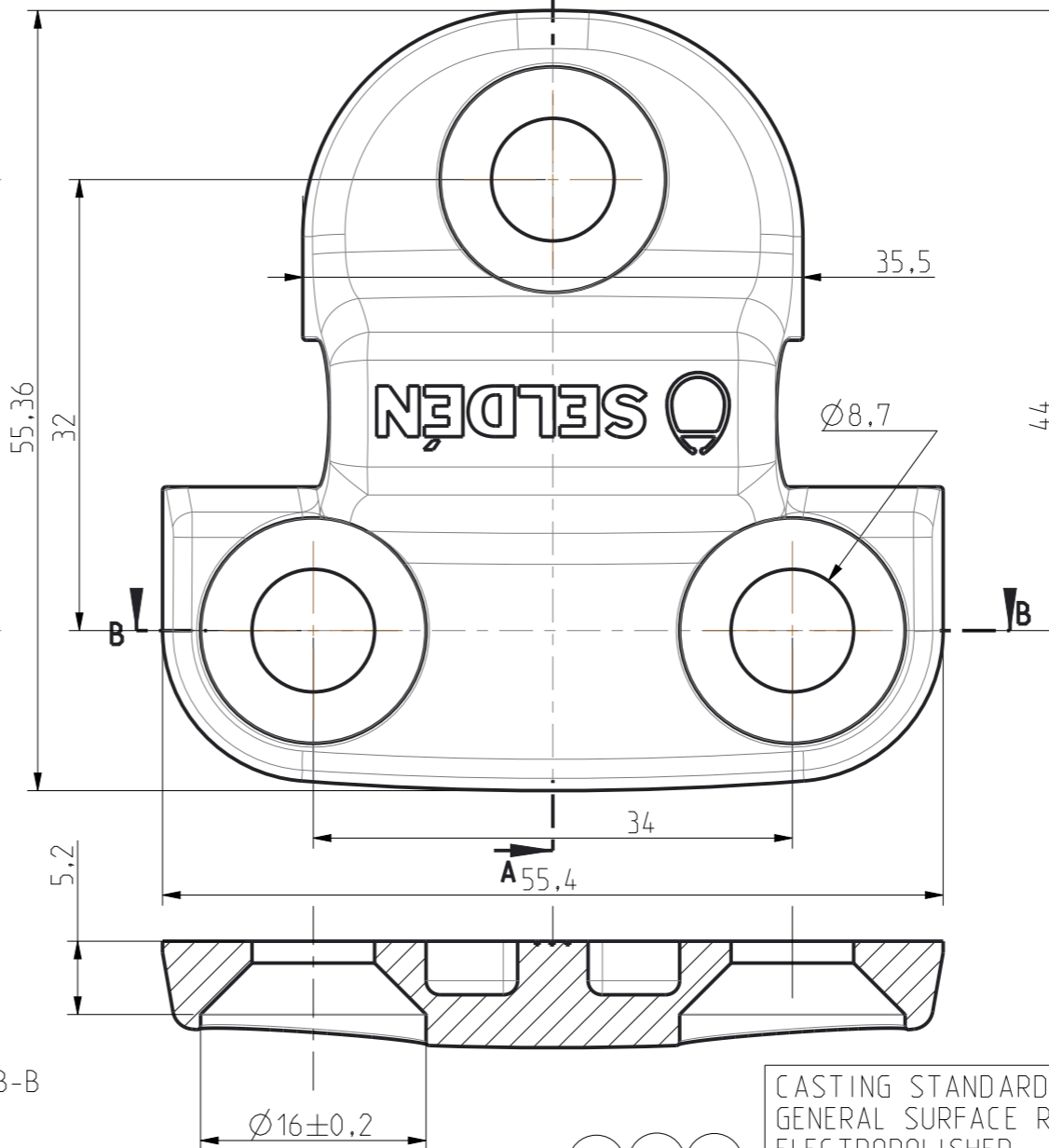
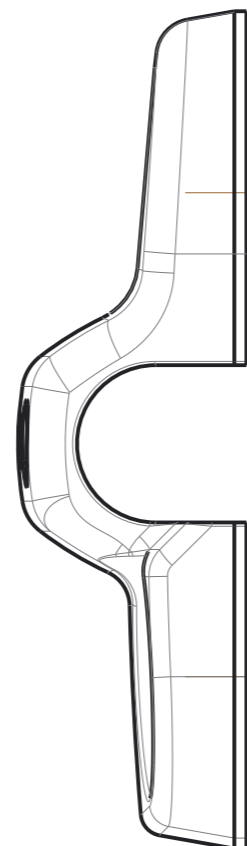
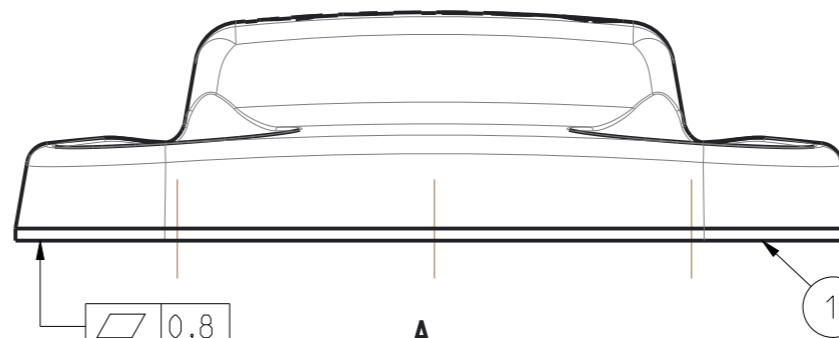
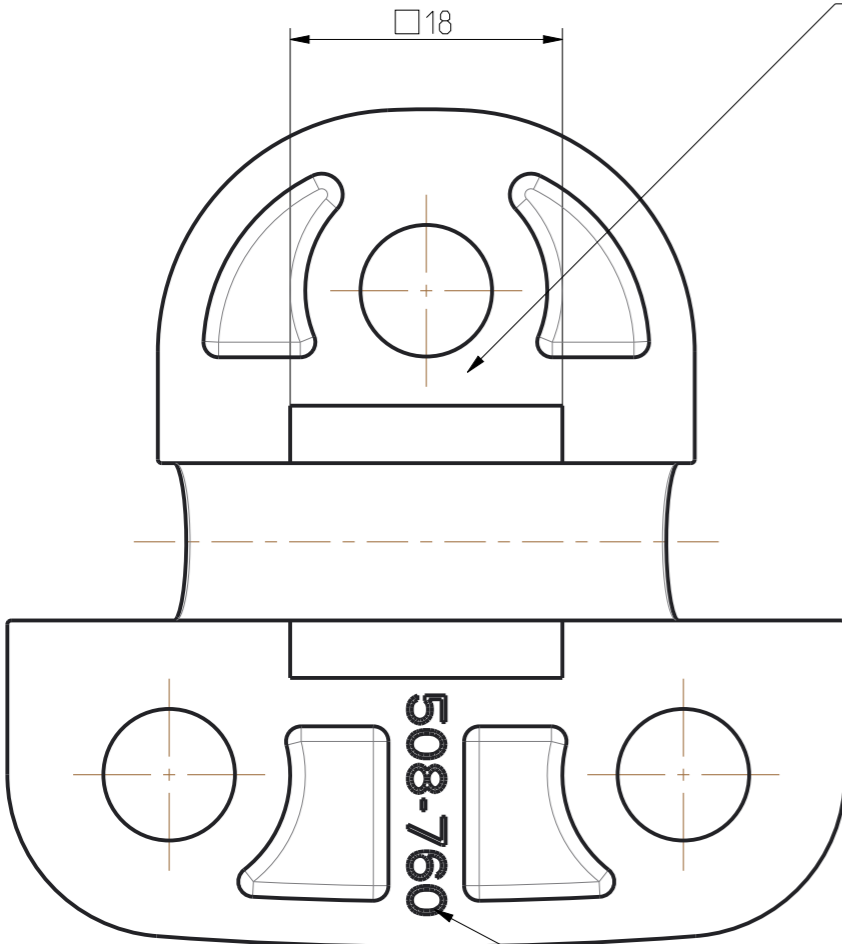

CASTING STANDARD: ASTM A744/A744M / SS-EN 10283
 GENERAL SURFACE ROUGHNESS: ≤ Ra 6.3
 ELECTROPOLISHED
 PASSIVATED IF HANDPOLISHED

5	1	TABLE CHANGED, NO HEAT TREATMENT OF CF8M	JUN 2015	PA
4	3	MATERIAL WAS 2205; "DPL" REMOVED; PART NO. MOVED; TREATMENT CLARIFIED	NOV-2014	EW
3	2	MTRL CHANGED; THREE HOLES INCREASED	11-03-08	EW
2	1	LOGOTYPE ROTATED 180 DEGREES	07-11-29	EW
1	1	0.8mm ADDED TO BOTTOM SURFACE	05-11-03	EW
No	Qty	Revision	Date	Sign

		PADEYE BASE 54X54X15 FOLDABLE PADEYE Ø8			
		Material	Estimated mass properties:	Weight	Volume
(3) (4) CF-8M		Replaced by	Replacing	Approved date 2015-06-16	File D410 /A3
Tolerance acc. to SS-ISO 2768-m unless otherwise stated	Drawn EW	Date 05-08-24	Scale 2:1	Revision 5	Release Production
		Approved EW	Part No. 508-760		